



MW-1 (Well screened from 22 to 27 ft bgs, bottom elevation of 428.74 ft AMSL)	
Soil (ug/kg)	0.0 - 2.0': 1.0; 2.0 - 4.0': 2.4
Groundwater (ng/L)	<RL(20) (Round 1)
Groundwater (ng/L)	<RL(20) (Round 2)

MW-2S (Well screened from 9 to 19 ft bgs, bottom elevation of 441.18 ft AMSL)	
Groundwater (ng/L)	1,100 (Round 1)
Groundwater (ng/L)	750 (Round 2)

MW-2 (Well screened from 35 to 45 ft bgs, bottom elevation of 415.69 ft AMSL)	
Soil (ug/kg)	0.0-2.0': 1.3/1.5; 2.0-4.0': 0.35/0.41
Groundwater (ng/L)	18,000 (Round 1)
Groundwater (ng/L)	17,000/16,000 (Round 2)

MW-3 (Well screened from 4 to 19 ft bgs, bottom elevation of 417.82 ft AMSL)	
Soil (ug/kg)	0.0 - 2.0': 2.5; 2.0 - 4.0': 0.67
Groundwater (ng/L)	5,300/4,200 (Round 1)
Groundwater (ng/L)	4,300 (Round 2)

MW-1S (Well screened from 5 to 15 ft bgs, bottom elevation of 440.28 ft AMSL)	
Groundwater (ng/L)	<RL(20) (Round 1)
Groundwater (ng/L)	60 (Round 2)

MW-5 (Well screened from 6 to 21 ft bgs, bottom elevation of 412.08 ft AMSL)	
Soil (ug/kg)	0.0 - 2.0': 1.4; 2.0 - 4.0': 1.2
Groundwater (ng/L)	580 (Round 1)
Groundwater (ng/L)	570 (Round 2)

MW-4 (Well screened from 11 to 26 ft bgs, bottom elevation of 405.09 ft AMSL)	
Soil (ug/kg)	0.0 - 2.0': 4.1; 2.0 - 4.0': 1.8
Groundwater (ng/L)	1,700 (Round 1)
Groundwater (ng/L)	1,400/1,400 (Round 2)

- LEGEND**
- SITE PROPERTY BOUNDARY (APPROXIMATE)
  - BUILDING OUTLINE
  - ~ TREELINE
  - - - HOOSIC RIVER GREENWAY
  - ☐ TRANSFORMER (PAD MOUNTED)
  - ⊕ MW-1S MONITORING WELL IN PERCHED ZONE
  - ⊕ MW-2 428.87 MONITORING WELL WITH GROUNDWATER ELEVATION (IN FEET AMSL)
  - 424 — GROUNDWATER ELEVATION CONTOUR AS MEASURED ON SEPTEMBER 2, 2015 (IN FEET AMSL)
  - ➔ INFERRED GROUNDWATER FLOW DIRECTION

Note:  
 Soil sampling was conducted August 5-13, 2015.  
 Round 1 of groundwater sampling was conducted September 2 and 3, 2015.  
 Round 2 of groundwater sampling was conducted September 30 and October 1, 2015.  
 RL = Reporting Limit

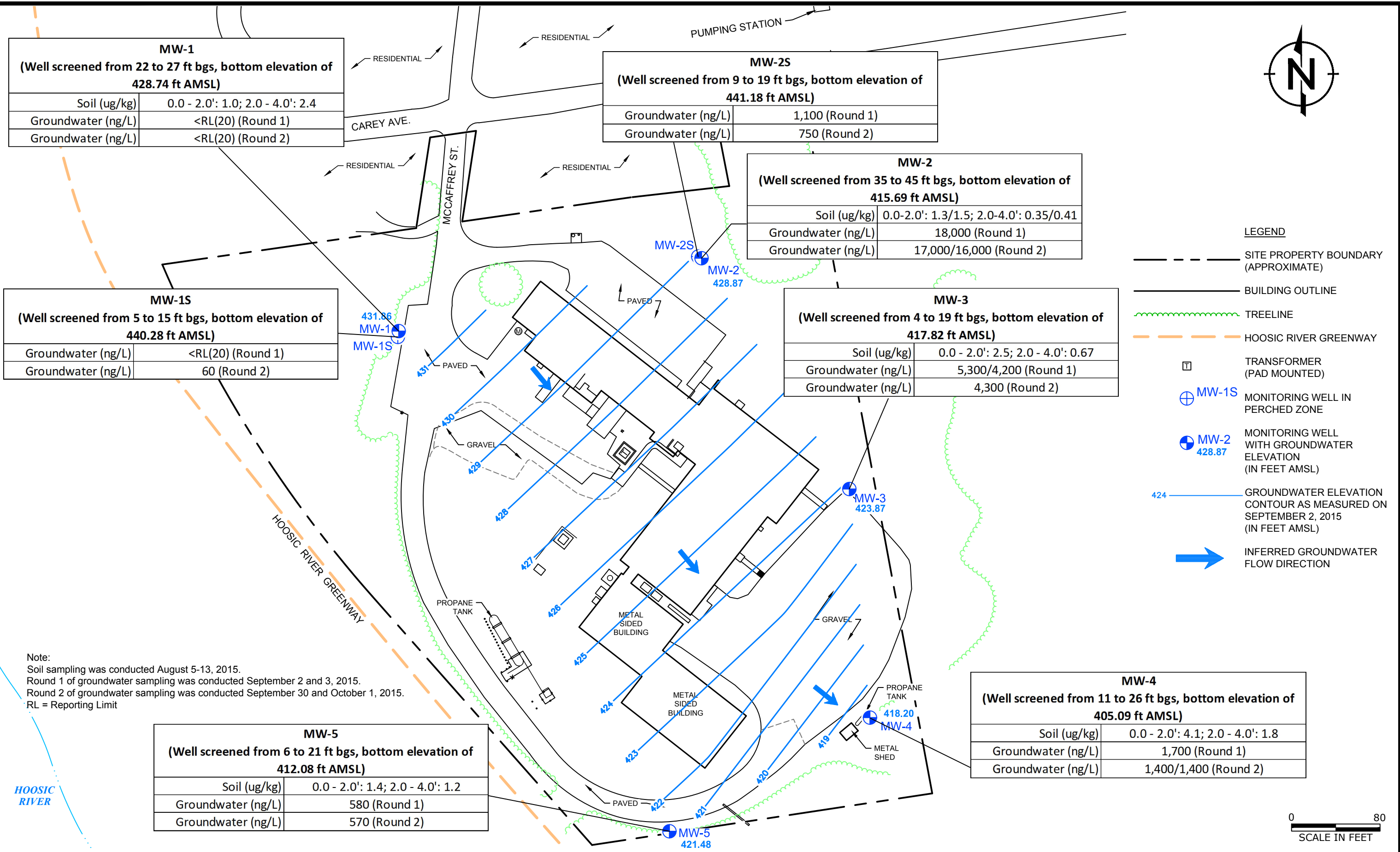

**PFOA SAMPLING RESULTS FOR SOIL AND GROUNDWATER (AUGUST - OCTOBER 2015)**

SAINT GOBAIN PERFORMANCE PLASTICS  
 McCAFFREY STREET PLANT  
 HOOSICK FALLS, NY

FIGURE

TPENNISI 11/23/15 F:\0237128\_SGPP\CLIENT\_REVIEW\_NOV 2015 < DATA\_PFOA\_(AUG-SEP 2015)\_HOOSICK FALLS NY\_0237128 >